

US Fed Spec Heavy Duty Thimbles

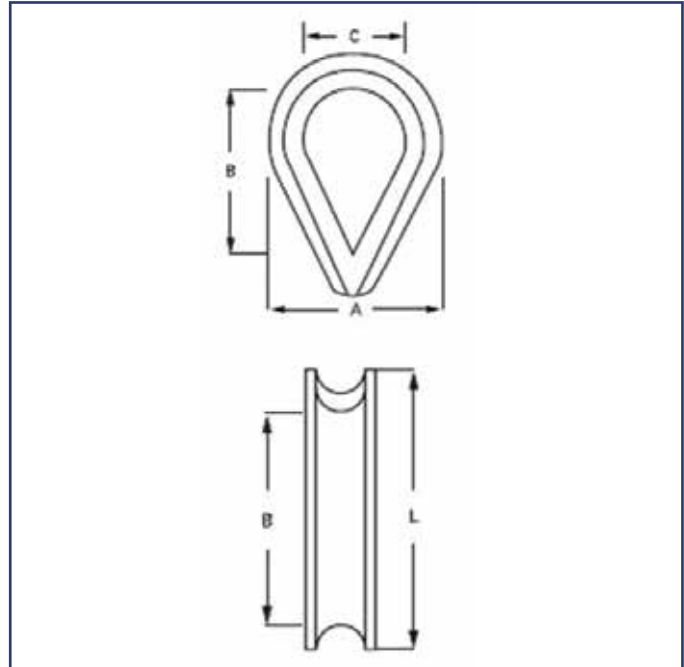

Rope Diameter (inches)	L (inches)	A (inches)	B (inches)	C (inches)	Weight (kgs/100)
1/4	2.3/16	1.1/2	1.5/8	7/8	3.4
5/16	2.1/2	1.1/16	1.7/8	1.1/16	6.3
3/8	2.7/8	2.1/8	2.1/8	1.1/8	11.3
7/16	3.1/4	2.3/8	2.3/8	1.1/4	16.2
1/2	3.5/8	2.3/4	2.3/4	1.1/2	23
9/16	3.5/8	2.11/16	2.3/4	1.1/2	23
5/8	4.1/4	3.1/8	3.1/4	1.3/4	33.8
3/4	5	3.13/16	3.3/4	2	66.2
7/8	5.1/2	4.1/4	4.1/4	2.1/4	83.3
1	6.1/8	5.15/16	4.1/2	2.1/2	135
1.1/8-1.1/4	7	5.7/8	5.1/8	2.7/8	184.5
1.3/8-1.1/2	9	7.1/8	6.1/2	3.1/2	540
1.5/8	1.11/4	8.1/8	8	4	731.3
1.3/4	12.13/16	8.1/2	9	4.1/2	810
1.78-2	15.1/8	10.3/8	12	6	1,170
2.1/4	17.1/8	11.7/8	14	7	1,935