

Swage Fittings Stainless Steel Swage Jaw

Material: AISI 316
Polished finish

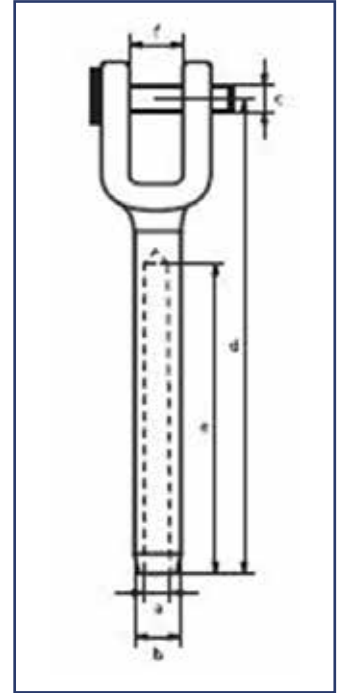

Wire Dia (mm)	a (mm)	b (mm)	c (mm)	d (mm)	e (mm)	f (mm)	Weight (kgs/100)
3	3.3	6.3	5.2	65	32	7.5	2
4	4.3	7.5	6.2	77	40	10	5
5	5.3	9	8.7	88	57	12	7
6	6.3	12.5	9.7	106	63	14	14
8	8.3	16	14.6	145	85	16	22
10	10.3	17.8	16.5	150	89	17	52