

# Commercial Thimbles

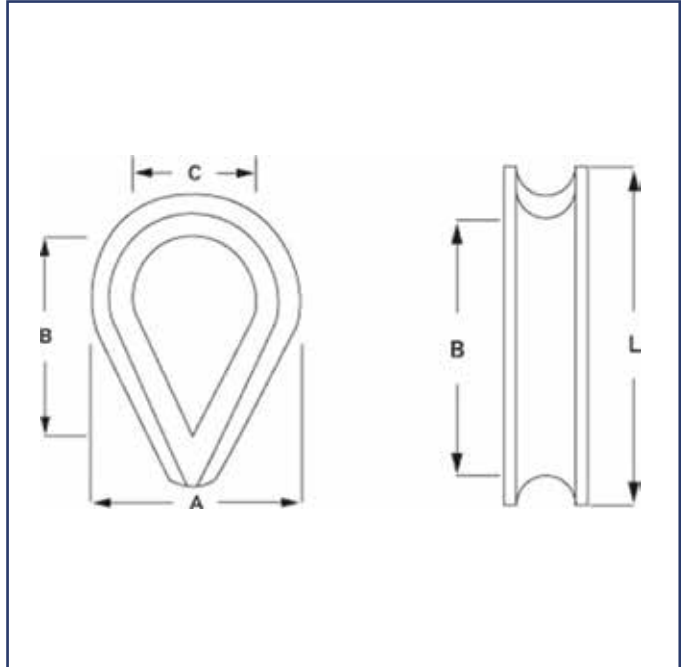

Rope Diameter (mm)	L (mm)	A (mm)	B (mm)	C (mm)	Weight (kgs/100)
2.5	22	16	19	12	0.5
3.5	26	17	21	13	0.8
4	25	19	16	11	0.4
5	31	22	22	16	0.8
6	37	29	26	19	1.4
8	51	38	34	24	2.8
10	64	44	42	32	4.8
12	76	57	51	38	8.0
14	82	60	57	40	10.0
16	89	64	60	42	15.0
18	102	69	67	45	22.0
20	115	79	76	51	25.0
22	127	89	83	54	32.0
24	140	102	88	64	46.0
26	152	105	102	68	66.0
28	165	115	110	73	77.0
30	178	121	115	79	80.0
32	203	133	140	93	130.0
36	229	184	177	115	540.0
40	254	206	198	120	730.0